

ONEFABRIC®

Graphic Installation

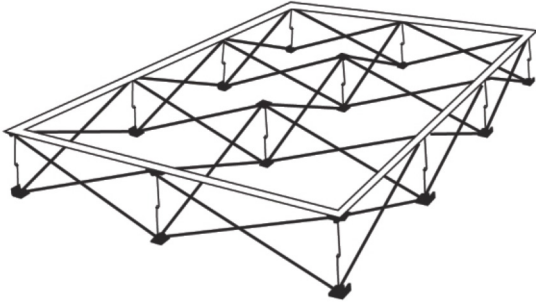

1

Assemble frame and lay flat on its back.
Remove existing graphic.

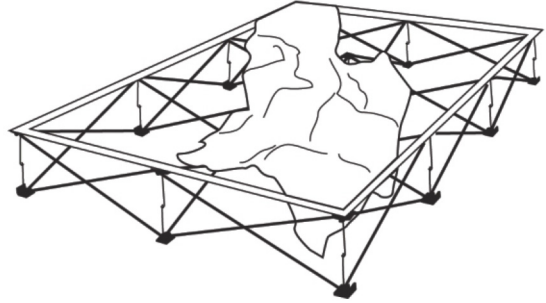

2

Starting at one corner, attach Velcro® on graphic to Velcro® on frame.
Overlap Velcro® of graphic a 1/4" on all sides of Velcro® of frame.
Note: Velcro® should not be flush.

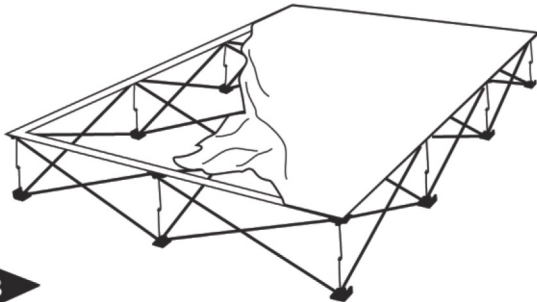

3

Work in continuous direction around the frame
until graphic is completely attached.



4

If needed, adjust Velcro® for taut fit.

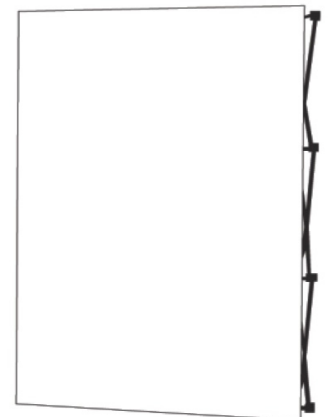

WARNING! DO NOT FORCE CLOSED.

To avoid damage, all hooks must be
disconnected before collapsing frame.

ONEFABRIC®

Setup Instructions



1 Remove frame and graphic from bag.



2 Ensure "adjustable knobs" of frame are on the floor. Pull up display into upright position.

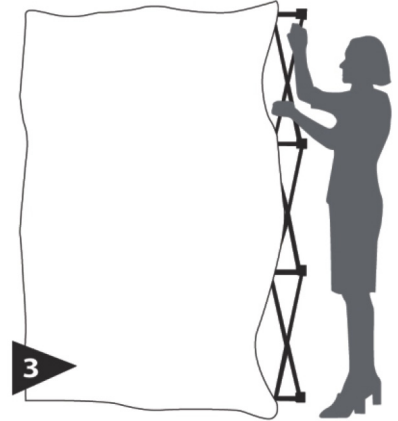

3 Lock all hooks between front and back hubs.

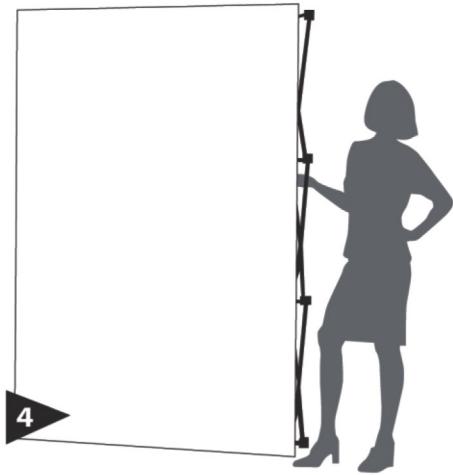

4 Adjust leveling knobs for desired angle. OneFabric™ display can now be moved easily into position.

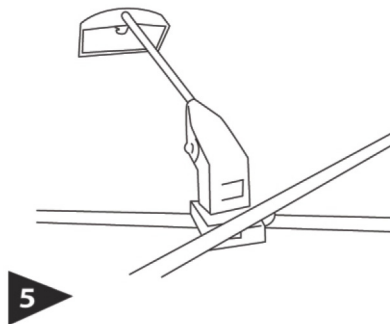

5 **OPTIONAL**
Attach lights to top of frame by sliding the plastic X Blocks under the frames cross sections.

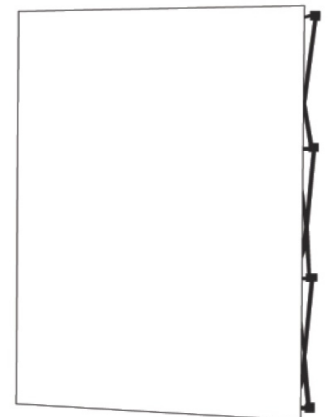

WARNING! DO NOT FORCE CLOSED.

To avoid damage, all hooks must be disconnected before collapsing frame.